

**chichester
festival
theatre**



Visual Story for the Minerva Theatre

Welcome

Welcome to the Minerva at Chichester Festival Theatre (we sometimes call it CFT for short), we're so pleased to have you here! This Visual Story is designed to help you familiarise yourself with the site before you arrive. It contains images and information to help you find your way. If you need any more information after reading it please contact our Access Team on **access@cft.org.uk** or call our Box Office on **01243 781312**.

Getting here

By Car

Chichester is easily accessible by road. The M27 and A27 run along the coast, linking Hampshire, Sussex and Kent. The M3, A3, A29, A259 and A24 connect Portsmouth, Southampton, Mid-Sussex and London.

Parking

Northgate Car Park is a 900-space pay and display car park next to the Theatre (charges until 8pm).

Blue Badge holders can park anywhere in Northgate Car Park free of charge. There are 9 non-reservable spaces close to the Theatre entrance.

The car park can get super-busy (especially on matinee days and during holidays).

By Rail

Chichester Station is a 20 minute walk from CFT, with regular direct links to London Victoria, Brighton, Portsmouth, Southampton, and Gatwick Airport. Trains to London Waterloo connect at nearby Havant. Call 08457 484950 for timetables and other details or visit nationalrail.co.uk

When you get to CFT

The Minerva Theatre is located opposite the Festival Theatre (shown in this image) next to a large park called Oaklands park. We have two theatre spaces at CFT – the Festival Theatre and the Minerva Theatre (where you will be heading).



On the other side of the Theatre is Northgate car park which is pay and display. Blue Badge holders can park anywhere in Northgate Car Park free of charge. There are 9 non-reservable spaces close to the Theatre entrance. You can see the theatre on the far side of the car park.



This is the view of the Theatre from Northgate Car Park; we do have some building works on both sides as you enter the site. You can see the Minerva on the left-hand side with the golden sign of a lady with an owl. Head towards the theatre when you are ready. You will see a set of doors opposite a statue.



Inside the Theatre

When you enter the Minerva Theatre you walk into the foyer. It can be noisy and busy but there is enough space for everyone. As you look to your right you will see The Brasserie restaurant.

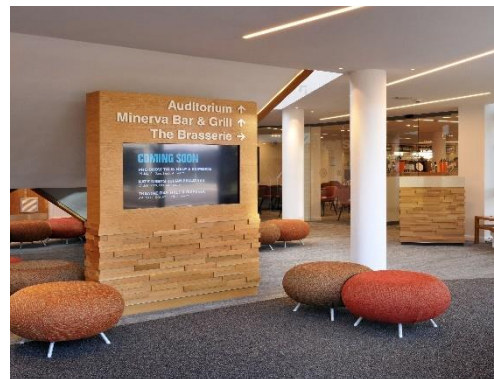

As you look to your left you will see the Box Office, which will be open an hour before the show starts. This is where you collect your ticket from a member of staff sitting behind the desk. Your tickets may have been emailed to you and you may also have received a text message from us with a link to your tickets. If you haven't had your tickets in this way, just pop along to our Box Office and our friendly staff will be happy to help.



In the centre of the foyer, you will see some colourful stools you can sit down on, and a staircase which takes you to the first floor. There is also a lift.

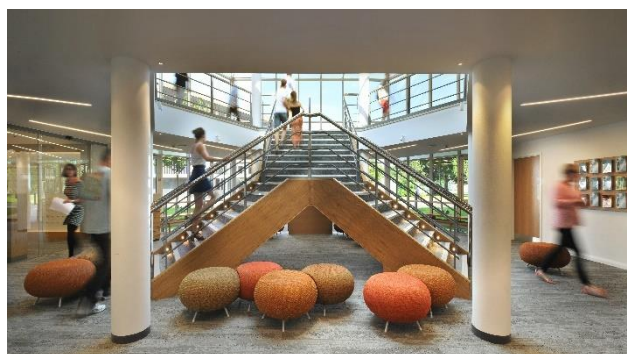

Men's, Ladies and Accessible toilets are available on both floors of the Minerva Theatre foyer. To help you find them look for the toilet symbols above the doors.



chichester festival theatre

On the first floor there is the Minerva Bar (or Play Café), where you can buy drinks and snacks before the performance. It has been decorated with lights, trees and snowflakes to make it festive.

The Play Café is where you can find toys to play, read a book, enjoy colouring in or crafts. It is also where you can buy food and drinks.



In the foyer you can buy show programmes from staff members. If you need help or have any questions, there are plenty of friendly staff members in the foyer who can help you. They will be in blue t-shirts.



Going into the auditorium

The Minerva auditorium entrance is on the first floor. Turn right at the top of the stairs. You can enter the auditorium half an hour before the performance starts or you can wait in the foyer until you hear the announcement to say that the show is about to start.



chichester festival theatre

Please show your ticket to the member of staff on the door who will scan it to make sure it is correct. They will then direct you to the seat number that is shown on your ticket, so you know where to go next.

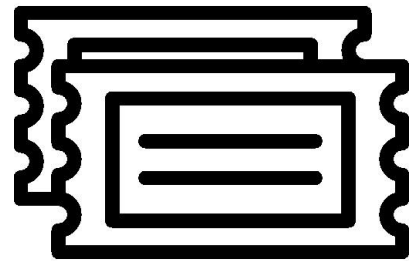

The auditorium is a large room with lots of seats all facing the stage. You may be sitting very close to the stage, or you may be seated quite high up, looking down on the stage.



The stage is the area where the actors perform. When it is time for the performance to start, the lights will be turned down and the auditorium will get darker. The actors will then walk onto the stage and the performance will begin.



Interval

There is not an interval for this production. But we offer a relaxed attitude to leaving the auditorium during our family shows. If you need to buy a drink or ice cream or visit the toilet you can leave and come back.



Before the show, you can find the ice cream seller outside the Theatre and Minerva Bar. There may be lots of people trying to buy ice cream so you may have to join the back of the queue and wait to be served. There are seven flavours: chocolate, vanilla, strawberry, salted caramel, ginger, coffee and mango sorbet (dairy free).

When it is time to go back into the auditorium, you will hear the same announcement in the foyer you heard when the performance first started.

After the performance

When the performance has finished audience members will clap their hands and make noise to show the actors they enjoyed the performance. The actors will bow to the audience to say thank you for watching them. You can join in if you want to. Some people might stand up to clap. You can join in or stay in your seat if you prefer.

At the end of the show, the cast will invite also everyone to join in a dance. You can join in by dancing in your seat or coming onto the stage if you'd like.

When the actors leave the stage, this means the performance has finished. The lights will get brighter in the auditorium and people will start to move around.



It will start to get very noisy and busy as people leave. Do not worry as there is plenty of space in the foyer for everyone.

We hope you enjoyed the performance; we look forward to seeing you again soon.

The CFT Team